

GLASS IS LIFE™

O-I makers of pure, sustainable, brand-building glass packaging

O-I Manufacturing Italy S.p.A.

Via 1° Maggio, 18
21040 Origgio(VA), Italy
Tel. +39 0243463.1

**CONTAINER & MOULD ENGINEERING
EUROPE**

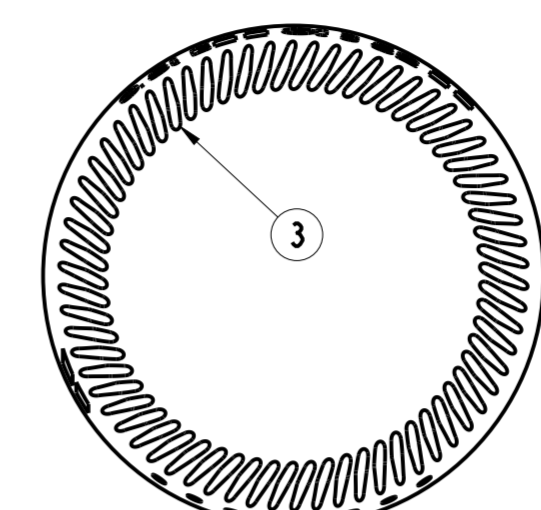
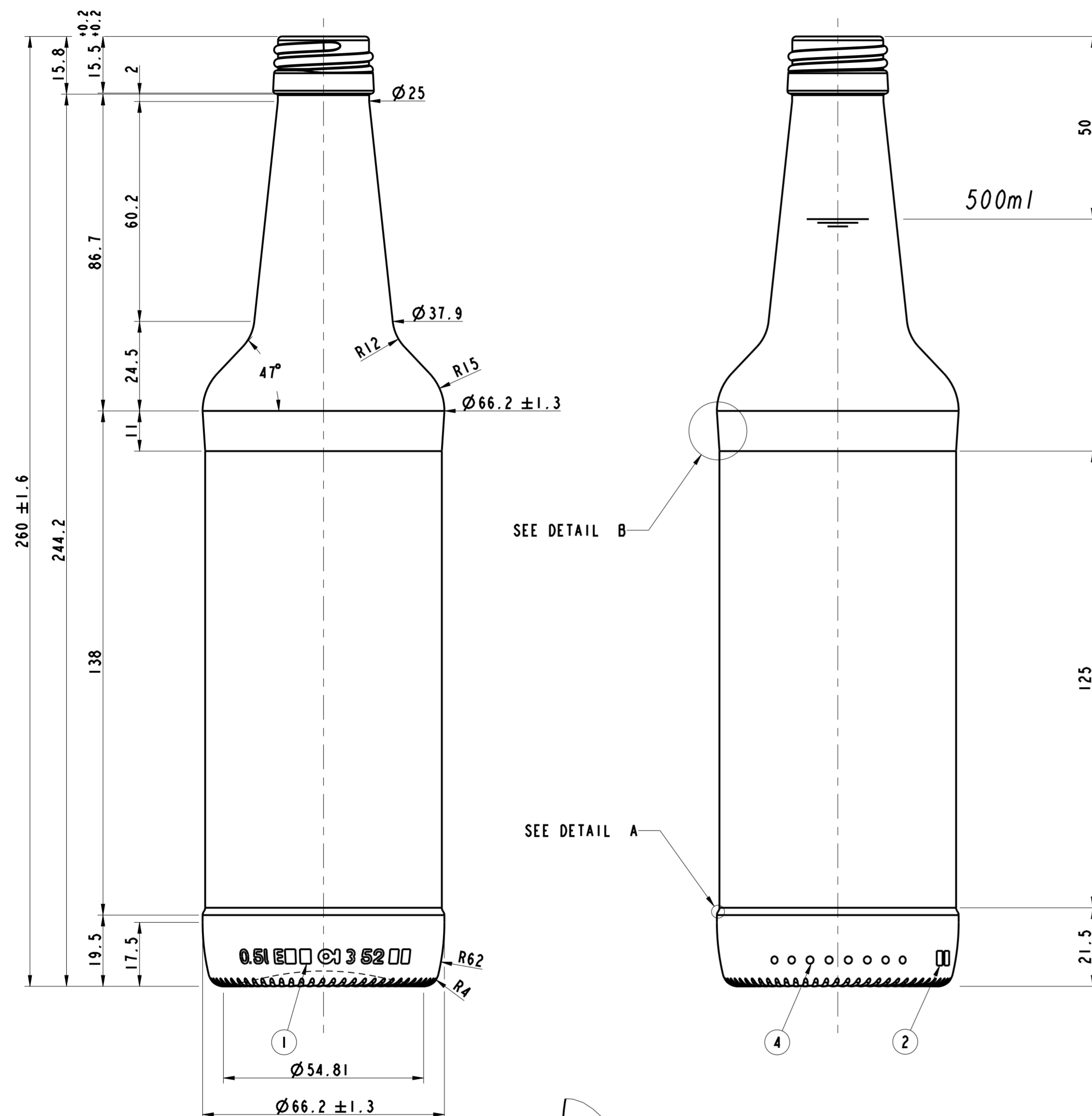

NOTES:
THIS DRAWING IS THE PROPERTY OF O-I AND MUST NOT BE REPRODUCED OR DISCLOSED WITHOUT O-I WRITTEN AUTHORIZATION.
ONLY TOLERANCED DIMENSIONS ARE GUARANTEED.
MANUFACTURING MARKINGS SHOWN ARE FOR ILLUSTRATIVE PURPOSES ONLY, ACTUAL MARKINGS ON CONTAINER MAY DIFFER, DEPENDANT ON LOCAL LEGISLATION.

1 = TRADEMARK
2 = CAVITY No.
3 = STIPPLING
THE SHAPE OF STIPPLES IS ONLY AN INDICATION AND THE CONSTRUCTION IS AT THE PRODUCTION PLANT DISCRETION.
4 = CAVITY CODE

SCALE 1:1

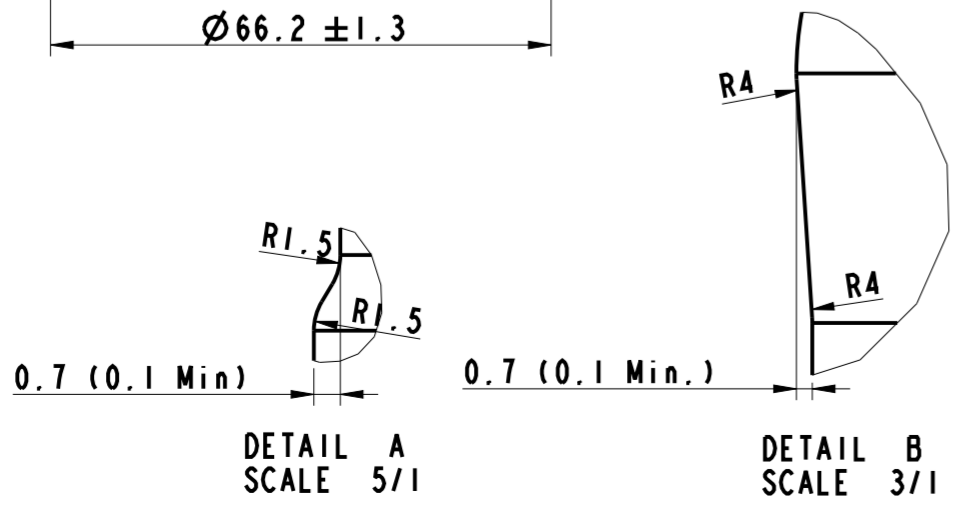

CATEGORY SPIRITS		TLT ANGLE 16°	
MAX. VERTICALITY TOLERANCE 2.9 mm		MEASURING CONTAINER YES	
FINISH SAP NUMBER 0627		FINISH REF. CETIE GME 30.06A 2007	
MINIMUM THROUGH BORE 16.5 mm		MAX FILLING TUBE \varnothing 15.0 mm	
CONTAINER OVERFLOW CAPACITY (BRIMFUL) 520ml \pm 10ml			
CONTAINER RATED CAPACITY (FILLPOINT) 500ml			
CONTAINER WEIGHT 260g APPROX.			
FINISH DESIGNATION PL.28.GME 30.06A.H158.0627		MAX GAS VOLUME	
PROCESS	RETURNABLE NO	DESIGN REF. 062130	
STANDARD 50 cl SPIRIT			
DESIGNER	NS	DATE	13/11/09
CHECKED		DATE	
DRAWING NUMBER 090833		MOULD/SAP NUMBER 090833	

No	DATE	REVISIONS	DESIGN/CHECK
	07.05.12	ADDED SHAPE CODE	CD
1	04.05.12	Modified finish weight and deep label panel	CD