

FINISH DESCRIPTION: Vacuum lug finish. Diameter 82 Regular

INSERT: NO

**GLASS IS LIFE™**

**O-I** makers of pure, sustainable, brand-building glass packaging

O-I Manufacturing Italy S.p.A.

Via 1° Maggio, 18  
21040 Origgio(VA), Italy  
Tel. +39 0243453.1

CONTAINER & MOULD ENGINEERING  
**EUROPE**

NOTES:  
THIS DRAWING IS THE PROPERTY OF O-I AND  
MUST NOT BE REPRODUCED OR DISCLOSED  
WITHOUT O-I WRITTEN AUTHORIZATION.

DIMENSIONS EXPRESSED IN mm  
ONLY TOLERANCED DIMENSIONS ARE GUARANTEED.

MANUFACTURING MARKINGS SHOWN ARE FOR ILLUSTRATIVE  
PURPOSES ONLY, ACTUAL MARKINGS ON CONTAINER  
MAY DIFFER, DEPENDANT ON LOCAL LEGISLATION.

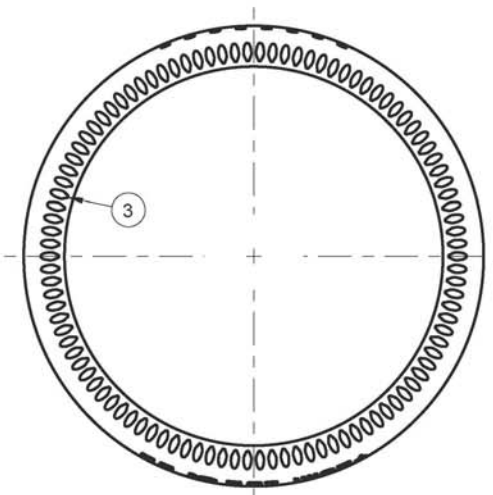
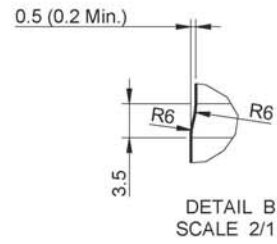
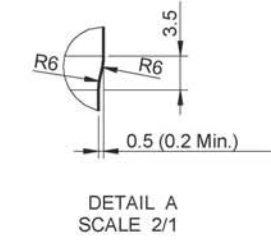
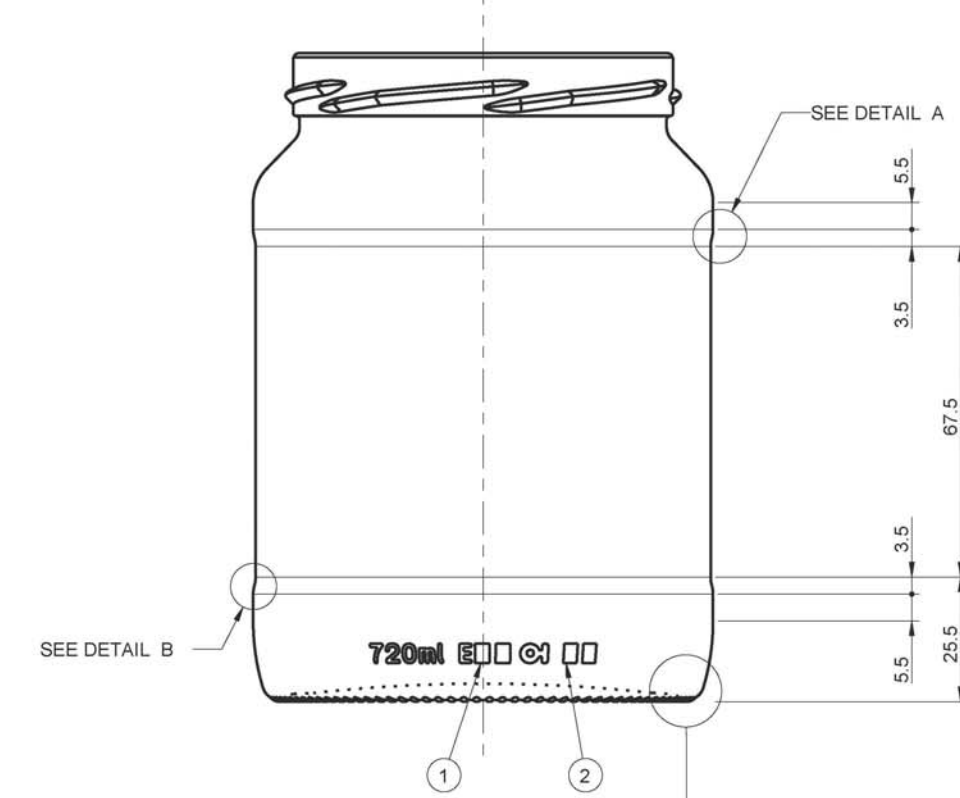
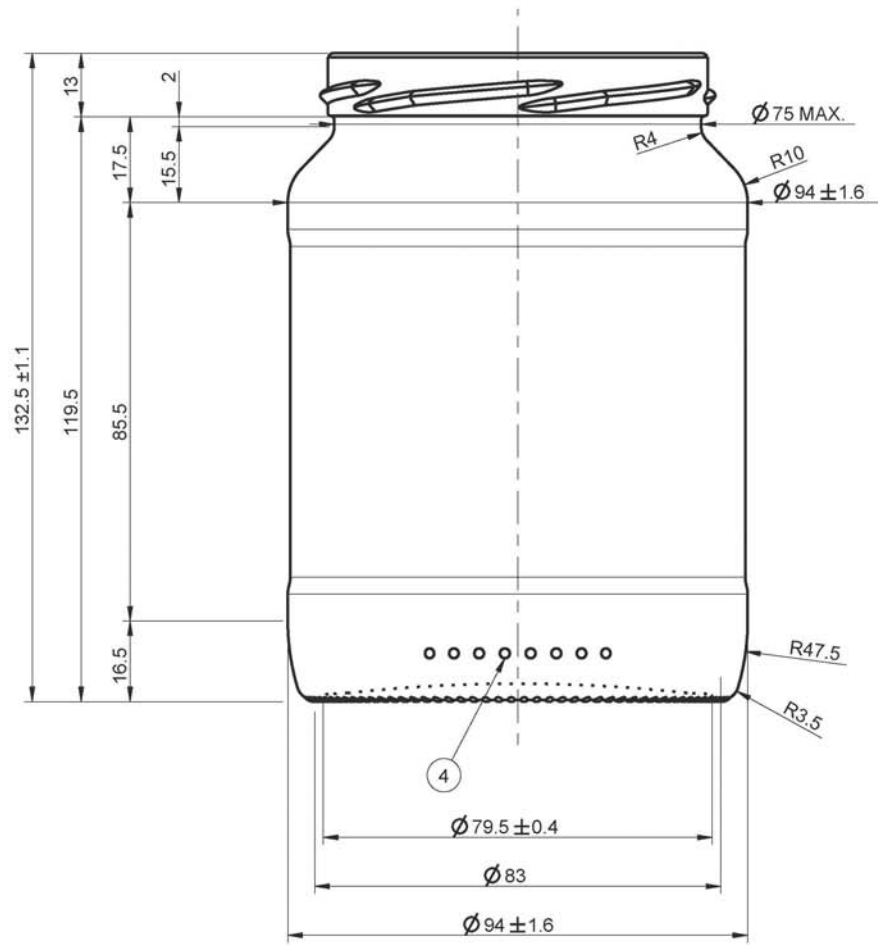

*Wayn Tonde*

Termék szám: **1258**  
Job number:

Dátum/Date: 2013-03-29

CATEGORY FOOD	TILT ANGLE 34.45°
MAX. VERTICALITY TOLERANCE 1.27 mm	MEASURING CONTAINER NO
FINISH SAP NUMBER 4976	FINISH REF. CETIE GME 20-09 1995
MINIMUM THROUGH BORE 70.8 mm	MAX FILLING TUBE Ø
CONTAINER OVERFLOW CAPACITY (BRIMFUL) 720ml ± 10ml	
CONTAINER RATED CAPACITY (FILLPOINT) 720ml	
CONTAINER WEIGHT 285g APPROX.	
FINISH DESIGNATION EU_82_GME 20-09_H130_4976	MAX GAS VOLUME
PROCESS	RETURNABLE NO
	DESIGN REF. IPSO 7242

<b>STANDARD</b> 72 cl STIX			
DESIGNER	CD	DATE	14/01/13
CHECKED		DATE	
DRAWING NUMBER	MOULD/SAP NUMBER		
130032	000000		

1 = TRADEMARK  
2 = CAVITY No.  
3 = STIPPLING  
THE SHAPE OF STIPPLES IS ONLY AN  
INDICATION AND THE CONSTRUCTION IS AT  
THE PRODUCTION PLANT DISCRETION.  
4 = CAVITY CODE

SCALE 1:1

**TENTATIVE**

No	DATE	REVISIONS	DESIGN/CHECK